

# MINI FRAC TANK



## STANDARD FEATURES

- 8,500 GALLON CAPACITY
- SUITABLE FOR LIQUID WASTE
- CAN BE EASILY MOVED BY ROLL-OFF TRUCK OR TRAILER
- SUITABLE FOR LIQUID WASTE
- 1/4" CONSTRUCTION
- STEEL SHOT BLASTED
- WELDS: ALL CONTINUOUS EXCEPT SUBSTRUCTURE CROSS-MEMBERS

## SPECIFICATIONS

- CAPACITY: 8,500 GALLONS (198 BBL)
- LENGTH: 235 3/4" TANK LENGTH / 278" OVERALL LENGTH
- WIDTH: 95 1/2" TANK INSIDE / 102" OVERALL WIDTH
- HEIGHT: 89 3/4" TANK HEIGHT / 106 3/4" OVERALL HEIGHT
- PLATFORM: OUTSIDE RAIL CONSTRUCTION (36" INSIDE RAILS)
  - (2) - 6"x 2" x 1/4" TUBING LONG SILLS /HD NOSE CONES/1" THICK OPEN HOOK
  - 1/4" PLATE A36 FLOOR (FLAT BOTTOM FLOOR CONFIG.)
  - 3"x 4.1# STRUCTURAL CHANNEL FLOOR CROSS-MEMBERS (16" ON CENTER)
  - 8" Sch40 x 8" LONG REAR PLATFORM ROLLERS
  - 4" O.D. x 6" LONG FRONT NOSE ROLLERS

# MINI FRAC TANK

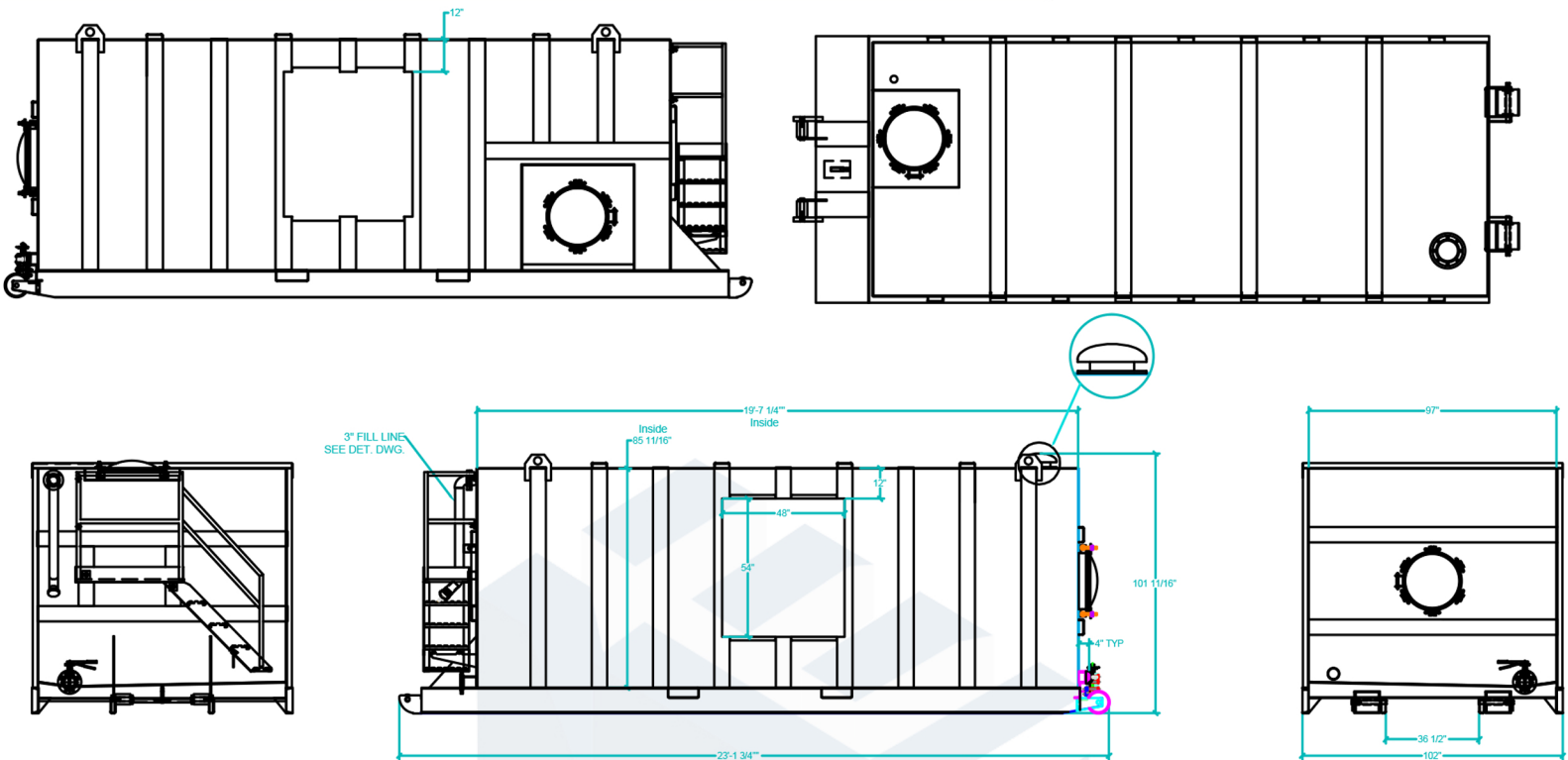

## SPECIFICATIONS (cont.)

- **SIDES:** 1/4" PLATE A36 / 6" x 2 3/4" x 3/16" FORMED SIDE STAKES
  - (1) 22" MAN WAY
- **FRONT:** 1/4" PLATE A36 / (2) - 1/4" FORMED HORIZONTAL SUPPORTS
  - (1) OUTLET PORT - 4" WELD NECK FLANGE 150# / 4" BUTTERFLY VALVE
  - (1) 3" FILL LINE W/ CAP
- **REAR:** 1/4" PLATE A36 / (2) - 1/4" FORMED HORIZONTAL SUPPORTS
  - (1) OUTLET PORT - 4" WELD NECK FLANGE 150# / 4" BUTTERFLY VALVE
  - (1) OUTLET PORT - 4" Sch40 NIPPLE / 4" FEMALE CAP
  - (1) 22" MAN WAY
- **ROOF:** 1/4" PLATE A36 / 6" x 2" x 1/4" FORMED ROOF MEMBERS
  - (1) 22" MAN WAY
  - (1) BLAYLOCK PRESSURE / VACUUM RELIEF VALVE
  - (1) 2" COUPLING W/ PLUG
- **BLAST:**
  - INTERIOR SURFACE PREPARATION: SSPC-SP-10 NEAR WHITE METAL BLAST
  - EXTERIOR SURFACE PREPARATION: SSPC-SP-6 COMMERCIAL BLAST CLEANING
- **PAINT:**
  - (INTERIOR) EPOXY 10% SOLID 20.0 MILS D.F.T
  - (EXTERIOR) FINISH COAT POLURETHANE 4.0 - 5.0 MILS D.F.T