

NATIONAL
TANK & EQUIPMENT

SPECIFICATIONS

- FLOOR: 3/16 PLATE ONE PIECE
- CROSSMEMBERS: 3 X 4.1 CHANNEL 16" ON CENTER
- WALLS: 3/16 PLATE ONE PIECE W/ TUBING TOP RAIL, INSIDE LINER HOOKS
- DOOR: 3/16 PLATE W/ TUBING FRAME
- FRONT: 3/16 PLATE SLANT FORMED
- PICK UP: STANDARD CABLE W/ 2 X 6 1/4 RAILS, GUSSET AT EACH CROSSMEMBER
- WHEELS: 4 EACH 10 DIA. X 9 LONG W/ GREASE FITTINGS
- DOOR LATCH: 4 INDEPENDENT RATCHET BINDERS W/ CHAINS, VERTICAL SECOND LATCH
- GASKETS: EXTRUDED RUBBER SEAL W/ METAL RETAINERS
- WELDS: ALL WELDS CONTINUOUS EXCEPT SUBSTRUCTURE CROSSMEMBERS
- FINISH: COATED INSIDE AND OUT W/ DIRECT TO METAL, RUST INHIBITING ACRYIC ENAMEL COLOR COAT
- HYDROTESTING: 22'-11" LONG (21'8" INSIDE), 99" WIDE (88" INSIDE)
- ROOF: 3/16 PLATE ROOF PANELS W/ TUBING & CHANNEL SUPPORT FRAME
- LIDS: 2- 68" X 90" METAL ROLLING LIDS SPRING LOADED, SELF RAISING
- ROLLERS: 4" V-GROVE ROLLERS W/ DELRIN BEARINGS & GREASE FITTINGS
- OPENING: 2- 60" X 82" OPENINGS W/ 8" DIVIDERS CENTERED ON CONTAINER
- LATCH: 2 INDEPENDENT RATCHET BINDERS W/ CHAINS PER LID
- GASKETS: EXTRUDED RUBBER SEAL WITH METAL RETAINERS

SPECIFICATIONS

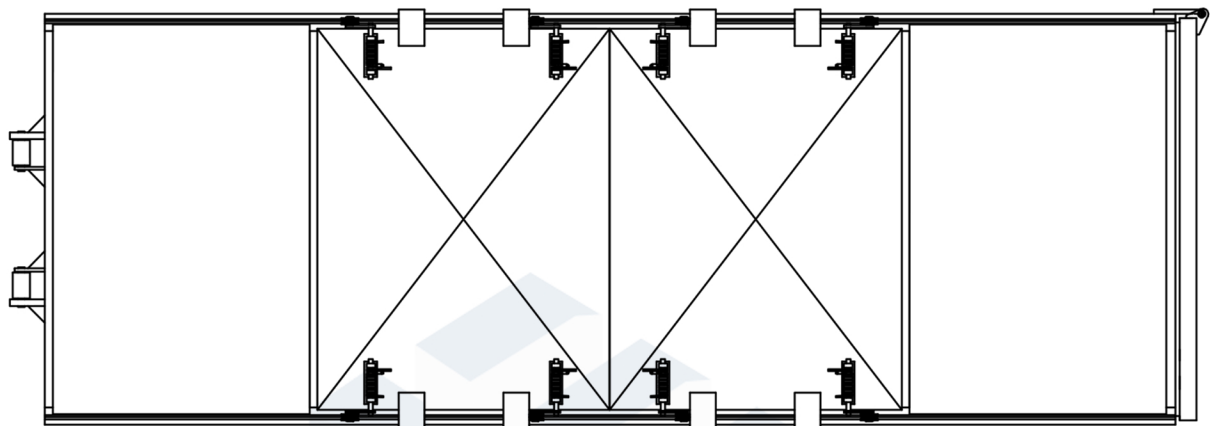

TOP VIEW.

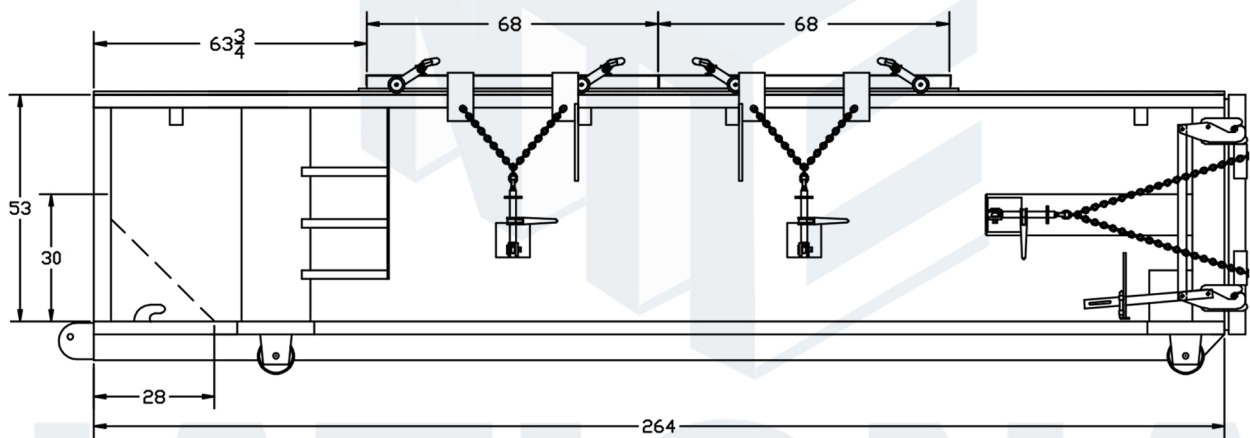

DRIVER'S SIDE ELEVATION VIEW.

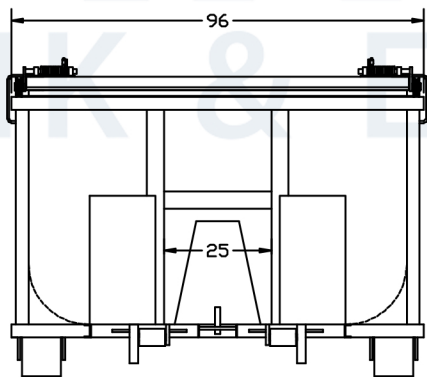

FRONT VIEW.

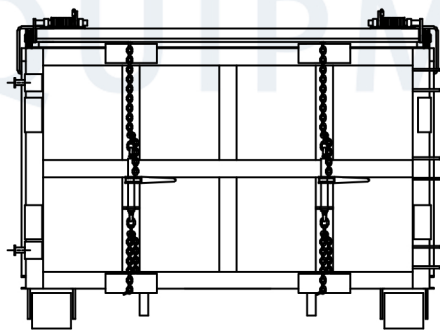

REAR VIEW.